

Audio Unit Removal/Installation

NOTE:

- Put on gloves to protect your hands.
 - Take care not to scratch the dashboard and related parts.
1. Make sure you have the anti-theft code for the radio, then write down the frequencies for the radio's preset buttons.
 2. Remove the dashboard center panel ([see page 20-89](#)).
 3. Remove the fore mounting bolts, then remove the audio unit.

Type 1:

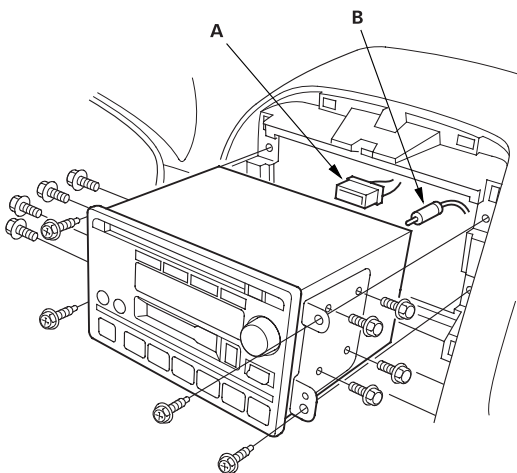

Type 2:

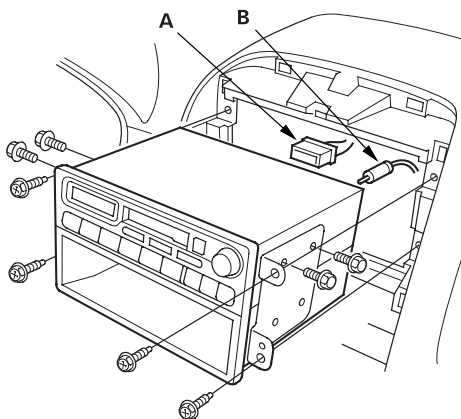

4. Disconnect the connector (A) and the antenna lead (B).
5. Install the audio unit in the reverse order of removal, and note these items:
 - Make sure the audio unit connector is plugged in properly, and the antenna lead is connected properly.
 - Enter the anti-theft code for the radio, then enter the customer's radio station presets.

Audio Unit Connector Replacement

Cavity	Wire	Connects to
1	YEL/GRN	Roof antenna
2	YEL/RED	ACC (Main stereo power supply)
3	—	Not used
4	RED/WHT	Security input
5	PNK	Right rear speaker (+)
6	BLU/WHT	Left rear speaker (+)
7	GRN/YEL	Front passenger's door speaker (+), Right tweeter (+)
8	GRN/BLK	Driver's door speaker (+), Left tweeter (+)
9	RED/BLK	Lights-on signal
10	WHT/RED	Constant power
11	—	Not used
12	—	Not used
13	—	Not used
14	—	Not used
15	BLU/YEL	Right rear speaker (—)
16	BLU/BLK	Left rear speaker (—)
17	GRY/RED	Front passenger's door speaker (—), Right tweeter (—)
18	LT GRN	Driver's door speaker (—), Left tweeter
19	RED	Gauge assembly
20	BLK	Ground (G503)

AUDIO UNIT 20P CONNECTOR

